

*Automatic*TM **FENDER**

Automatic Fender Installation and Operation Instructions



The Automatic Fender™ eliminates the need to climb onto the Bow to deploy fenders, significantly reducing the risk of falling or injury while docking! Now you can dock without leaving the cockpit, improving safety and eliminating hassle.



Your Boat may pull the fenders with a very significant force that creates tension on the fender line and may cause serious injury, particularly if a body part is wrapped in the line.

USE THE AUTOMATIC FENDER SAFELY:

Stay clear while docking. Keep yourself and others away from the Automatic Fender while docking.

Do not touch the Automatic Fender (AF) while in operation. Make sure no one touches or pulls on any part of the Automatic Fender (AF) while it deploys or lifts.

Do not attempt to repair, open, or modify.
All repairs must be done by Boat Innovation® only.

Before docking, always verify that the fenders are deployed to the desired height and position/angle.

Do not use in rough weather.
Do not exceed the product's maximum ratings.

BATTERY WARNINGS

This unit contains a battery pack:

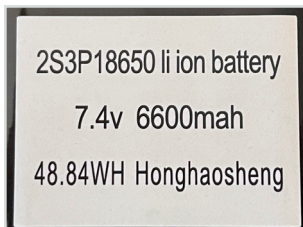

AUTOMATIC FENDER BOX CONTENT, PER PRODUCT:

- A fully assembled Automatic Fender (AF)
- Instruction manual
- Thank-you letter, hat and koozie
- Special parts box:
 - 5/16" - 18 2-1/4" bolt and 2 spare nuts.
 - Front clamps and metal clamps.
 - Rubber bushings & bolt covers.

For the installation video, scan the QR code with your phone's camera:

www.automaticfender.com/qrcode

SCAN THIS:



Please contact us with any questions that you may have at: support@BoatInnovation.com or +1-925-418-2448. Please add support@BoatInnovation.com to your contacts.

INSTALLATION TOOLS

- A P3 Screwdriver and a ½" Wrench.
- **Do not use an electric screwdriver or any other power tool**, as the bolts and nuts are stainless steel and may get welded together.



IDENTIFY THE FRONT & BACK OF THE AF



IDENTIFY THE PORT VS STARBOARD AF

On the bottom of each AF please find a label specifying its planned location:



On the sticker: first line specifies Bow vs Mid Ship vs Stern (in a single pair purchase, please disregard). Second line specifies Port vs Starboard. Please install accordingly to make sure the application matches the physical location of each AF.

On a port side AF, the rope comes from the left side, on a starboard AF, the rope comes from the right side of the AF:



PORT SIDE INSTALLATION

Start with the Port AF installation. The AF should be installed to the **right of the fender**, towards the Stern:

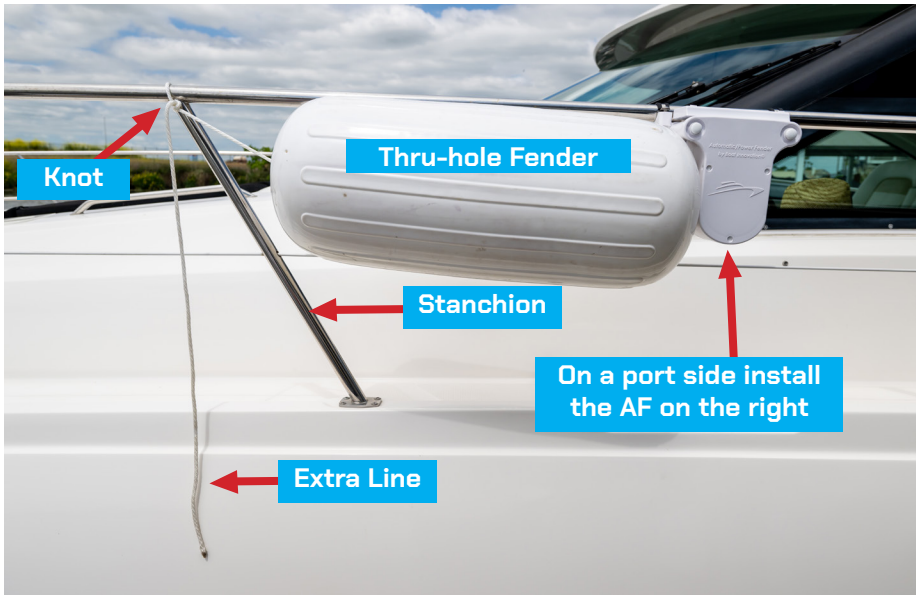

Remove only a **single** bolt and a single nut from each clamp. Make sure **not to lose the nuts**. Hang the Automatic Fender in front of the stanchion (towards the bow). Front of the AF facing out:

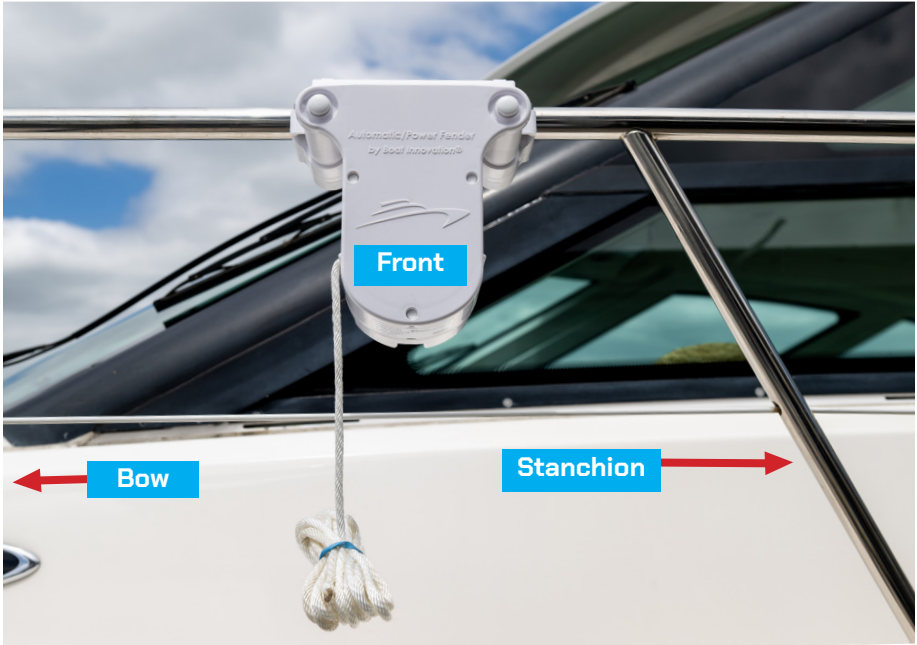

Tighten the bolts only **lightly** to allow clamp movement along the railing during the installation:



Use the smallest possible metal clamp. If the originally installed metal clamp is too small, you can replace it with a 16mm metal clamp [provided]. It is best to use the **smallest** possible metal clamp.

The metal clamps size is written on top.

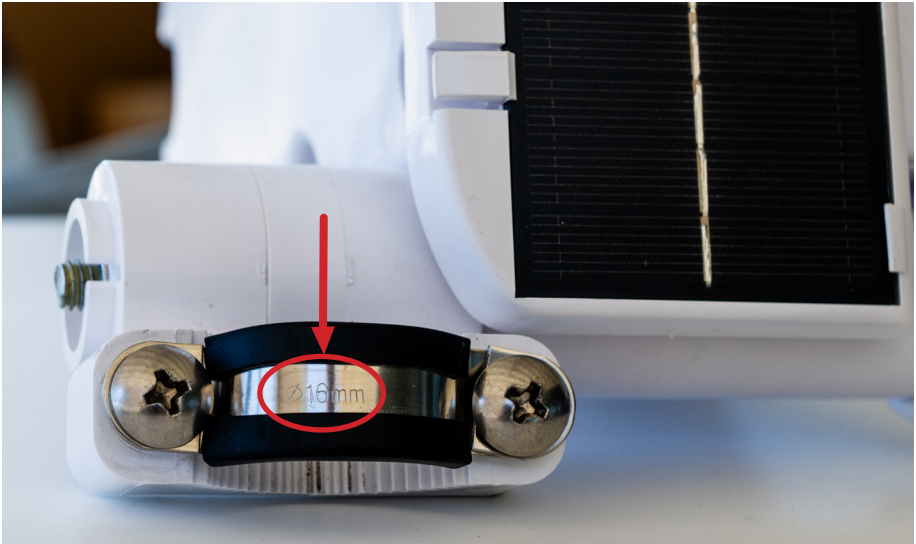

If the Boat has a **lifeline**, it should be placed **under or behind the AF** (not in front of the AF).



Make sure the lifeline is fully tightened and doesn't interfere with the fender's movement.

Always make sure that the nuts are fully inserted into the AF's clamp.

Proper nut placement:



Note: The nut lock is to the outside. The nut is fully inserted into the plastic groove.

Wrong placement, Nut is not fully inserted:

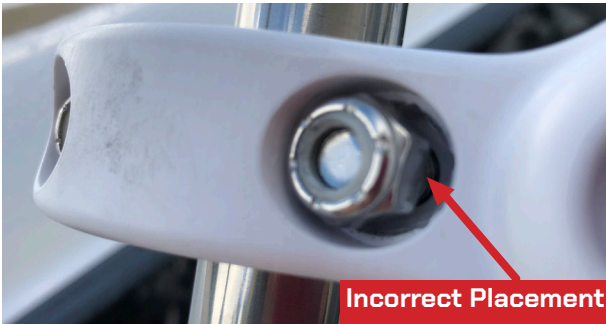

Remove the rubber band from the line, and run it through the fender's center hole:

Make sure the fender is properly inflated, flat fenders may get stuck on the rub rail!



Tie the rope to the railing in front of the stanchion, let the extra line fall downwards :

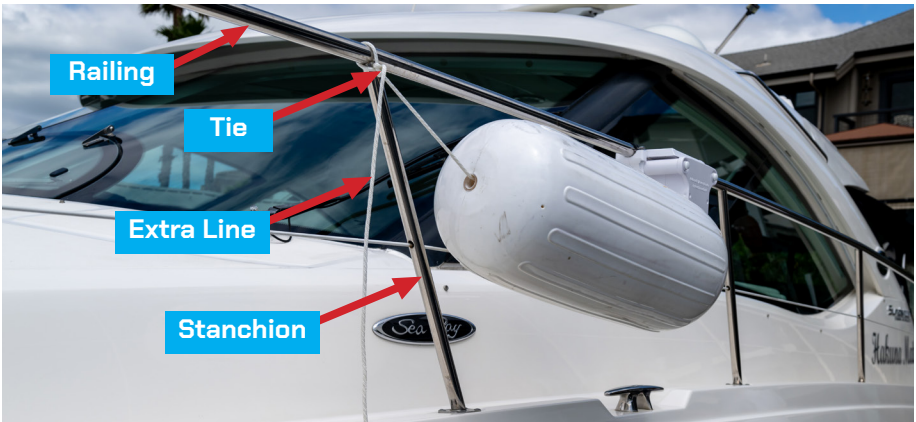

While the fender is touching the Automatic Fender:



The distance between the front side of the fender to the knot should be about 4 inches (10cm). Move the AF along the railing to achieve the desired distance:



Too little of a distance between the knot and the fender may cause the fender to get stuck and not deploy properly. If the fender is stuck, the rope may get tangled.

To support a railing height of up to 9', the AF comes with an 18' line. The average cruisers railing height is about 5.5'. We will now remove the extra line. Railing height = the height from water level to the top of the railing.

Lower the fender towards the water, pull or release the line until one side of the fender is lifted ~ 3 inches from the water level.



Tie the line to the railing in front of the nearest stanchion, do not skip a stanchion!



Wrap the extra line around the stanchion and secure it.



If the fender is sticking out or if you are having some other issue, please read the unique installation guidelines starting on page 27.

Move the bottom of the Automatic Fender outwards until it is beyond the Bow line. Make sure it is not exceeding the Rub rail line:

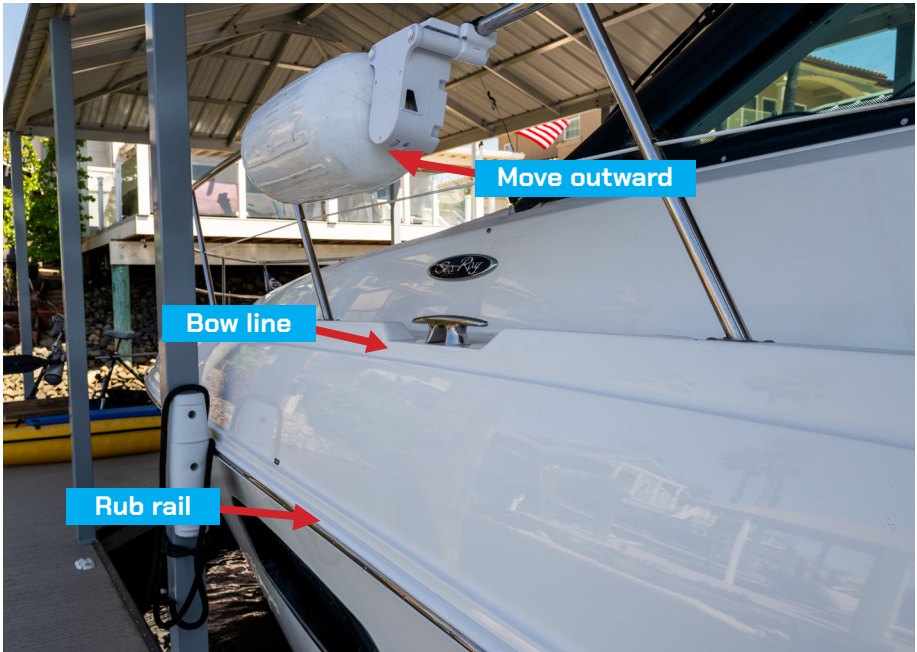

TIGHTEN THE BOLTS

Fully tighten all automatic fender clamp bolts. Please do not over tighten the bolts, just tighten them enough for the automatic fender to not droop. Over tightening bolts can cause the clamps to crack. If you need to make the clamp tighter use a smaller metal band.

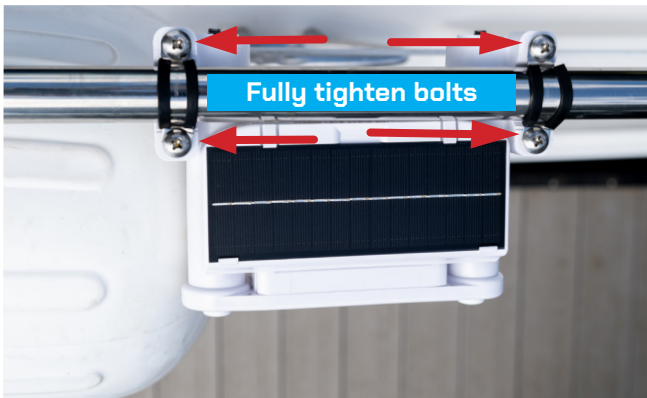

Install remaining Port, and then all Starboard AFs in the same manner.
In a starboard installation the AF is left to the fender, towards the stern:

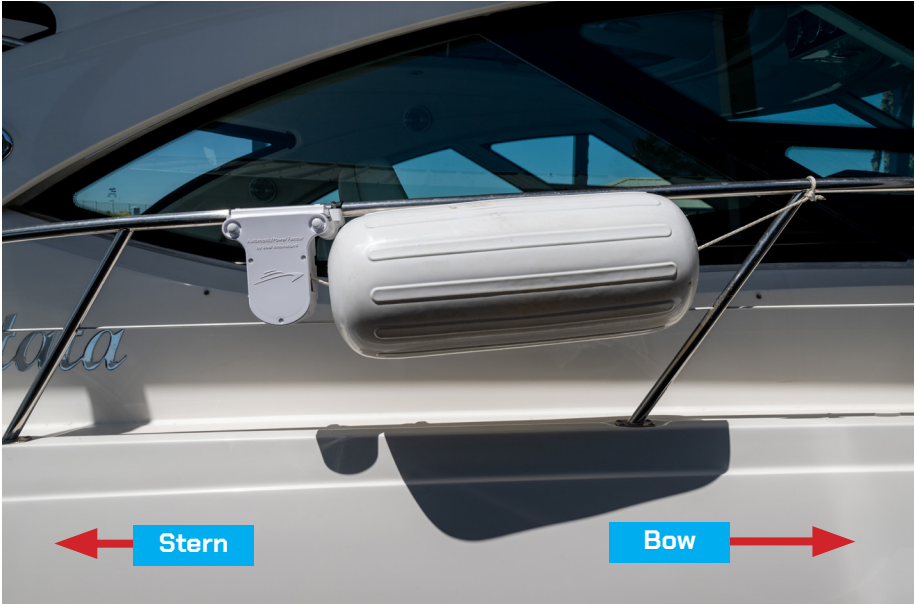

The Automatic Fender line must always wrap over the pulley (from the top):

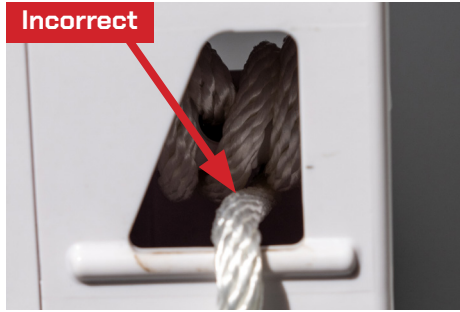
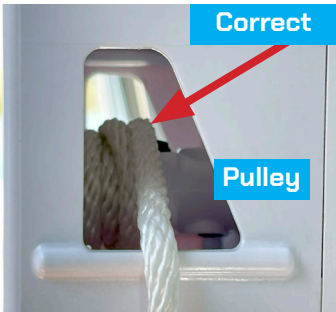

THE BOAT INNOVATION APPLICATION

Use or configure the application only after installing ALL PORT AND STARBOARD AFs and the fenders on the boat by following all installation steps. Configuring the application before fully installing all AFs may tangle the line and cause a malfunction.

Internet connectivity is required through the configuration stage.



Download the **Boat Innovation** application from the Apple or Android stores. You can also find a link on our web site: automaticfender.com/support

Certain features of the application require access to Location services. When prompted please select “While using the app”, otherwise the application will not work properly. As an example, location services enable notification if fenders are deployed while accelerating.

We do not sell or share any information.

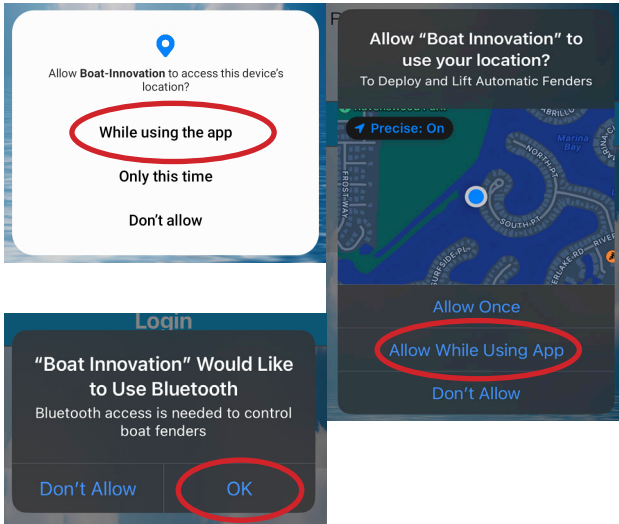

TROUBLESHOOTING

In case of a problem or a special installation, please refer to troubleshooting at: automaticfender.com/support
Or call us: + 1 [925] 418 2448.

SCAN THIS:



SAFETY: THE STOP BUTTON

Pressing on the “**Stop All**” button or **quitting/closing the application will stop** all fender movement. Please use this button as needed.



CONFIGURATION

For username enter the email address provided at purchase; the default password is: Innovation
The password is case sensitive.

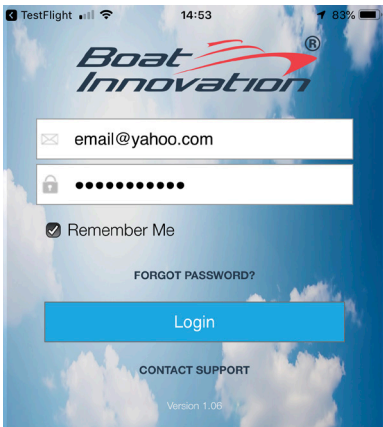

At first login, the application will direct you to the configuration page. You can always get to the configuration page through the main menu, by choosing  on the top right corner of the mobile screen, and then selecting the “**Configuration**” page from the drop-down menu:

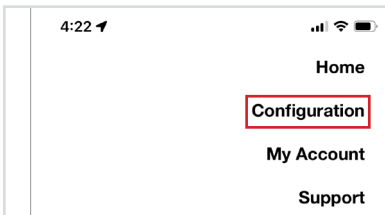

Configuration Page:

10:10

Configuration

Found: 4. Searching for more...

Port:
AF-88:D7:4F:E5

Port:
AF-D1:58:EF:9D

Starboard:
AF-FB:EE:39:76

Starboard:
AF-65:D9:90:AF

Boat Size

< 28'

28' to 45'

> 45'

Fly Bridge?

Yes

No

Full Size Cabin?

Yes

No

+

+

31

54

-

-

+

+

31

54

-

-

+

+

Rub (inc)

Dock (in)

-

-

+

+

54

31

-

-

+

+

54

31

-

-

+

+

Dock (in)

Rub (inc)

-

-

↑

Hold Lift

↓

Hold Deploy

↑

Rub Rail

↓

Dock

✖

Stop All

Save Config

To provide the best customer service, we need some information about your boat:

Boat Size	<input type="button" value=" < 28'"/>	<input type="button" value=" 28' to 45'"/>	<input type="button" value=" > 45'"/>
Fly Bridge?	<input type="button" value=" Yes"/>	<input type="button" value=" No"/>	
Full Size Cabin?	<input type="button" value=" Yes"/>	<input type="button" value=" No"/>	

Confirm that the Automatic Fenders are connected:

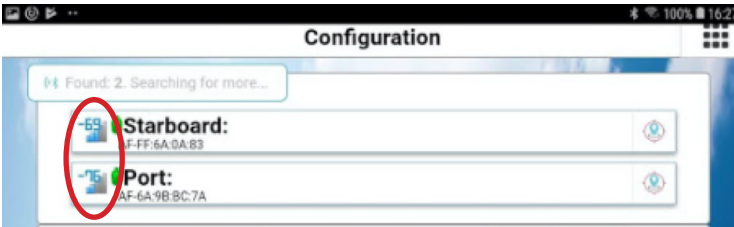

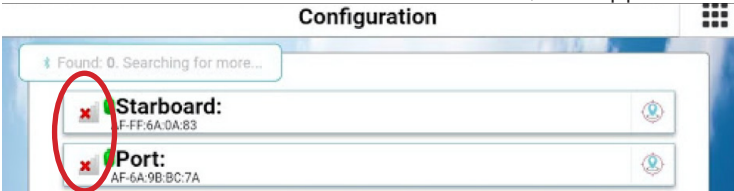

If the Automatic Fenders are not connected, the application will show:



In that case, refer to troubleshooting at: automaticfender.com/support

Get the fender to its lift position:

We will configure the AF's one at a time. Select an AF by pressing a fender icon . The selected fender will turn green .

Press and hold "Hold Lift"; until the line is tight and the fender stops moving up.



Do not use "Dock", "Rub Rail" or "Lift" until the installation is complete, as it may cause serious injury, particularly if a body part is wrapped in the line!

You can always release line by pressing and holding "Hold Deploy".

DEPLOYING

Make sure the fender is uninterrupted while deploying. The fender shouldn't stop on the boat's walkway or any other undesired location. An interrupted fender will cause line tangling. In such a case the fender may go up while it's deploying.

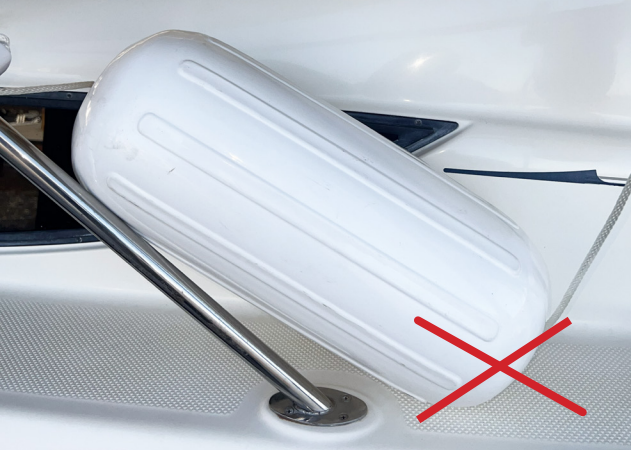

CONFIGURING RUB RAIL HEIGHT

From this point on make sure no one touches or pulls on any part of the Automatic Fender while in motion.

Select a fender  and press on **"Rub Rail"**.

The selected fender will be lifted all the way to the rail, and will perform a few short movements to confirm reaching the railing.



Then it will deploy to the default Rub rail level. It will stop shortly half way for calibration.



Adjust to the desired height by pressing + or - on the Rub rail line length:

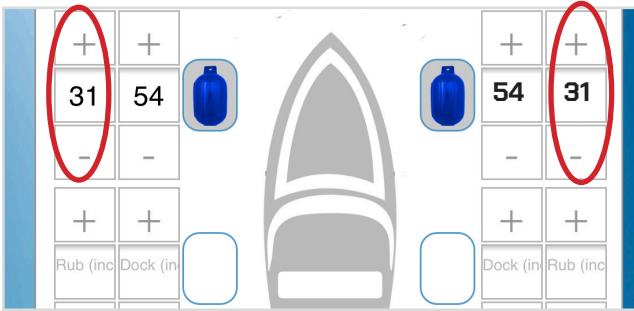

Press **“Rub Rail”** again to test the new line length.
Repeat these steps until the desired Rub rail line length has been achieved.

If the fender doesn't deploy in a consistent manner, refer to the troubleshooting document at automaticfender.com/support

CONFIGURING DOCK HEIGHT

Select a fender  and press on **“Dock”**:



The selected fender will be lifted all the way to the rail, and will perform a few short movements by the rail, before deploying to the default dock level.

Adjust to the desired height by pressing + or - on the dock line length:



Repeat until achieving the desired length.

CONFIGURING ALL AUTOMATIC FENDERS

Repeat these steps for each Automatic Fender.

SAVE CONFIGURATION

When adjusted to the desired height, click **“Save Configuration”**.

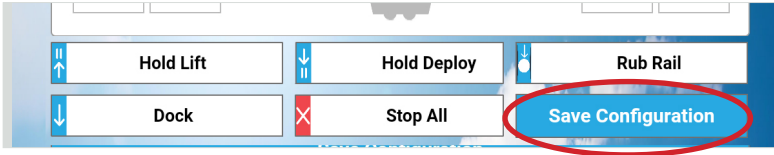

TESTING AND ENJOYING THE AUTOMATIC FENDERS

From the main menu , choose the **“Home”** page and test the different functionalities:

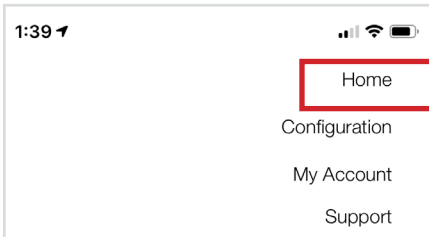

Press **“Lift”** and confirm that all fenders are lifted to rail level.

Press **“Dock Deploy”** to lower to dock height. Repeat the configuration stage if necessary.

The Automatic Fender line must always wrap over the pulley (from the top), if it wraps from the bottom please refer to troubleshooting:

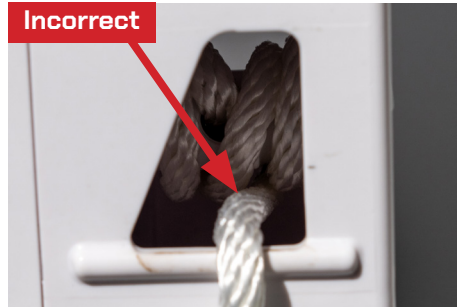
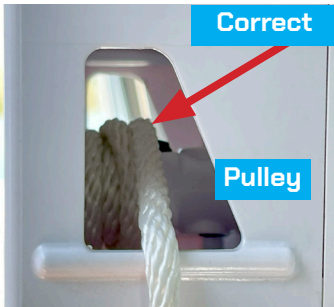

Before docking always confirm that the fenders are deployed to the correct height, and adjust line length if needed.

It is always best to deploy the fenders in calm waters (when entering the Marina). Choppy water may change their angle:

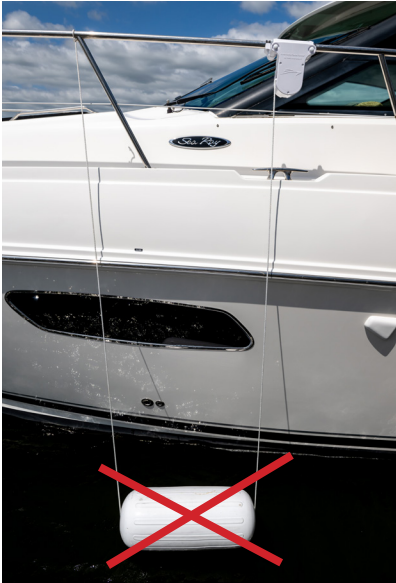

If the fender is horizontal, lift and deploy again.

Press **“Lift”** again to lift the fenders to rail level.

Press **“Dock Deploy”** to deploy to dock height. Repeat the configuration stage if necessary.

Press **“Toggle View”** to switch between control and hybrid view:

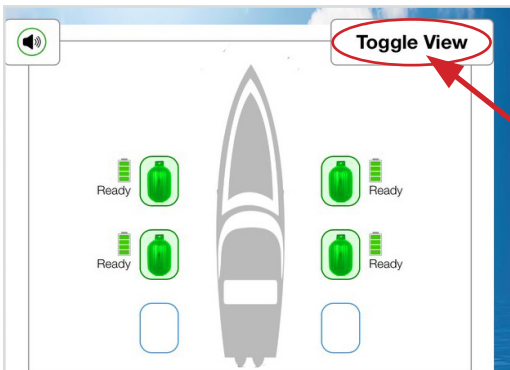

WHEN DOCKING WITH DOCK FENDERS:

When approaching a dock with fixed fenders (fenders attached to the dock), refrain from using the automatic fenders as this may cause the line to get stuck on a fixed fender and break the pulley. Only use the automatic fender or fixed dock fenders, never both.



CHANGING THE PASSWORD

From the main menu , choose **“My Account”**. Change the password from the default (**Innovation**) to your desired password.

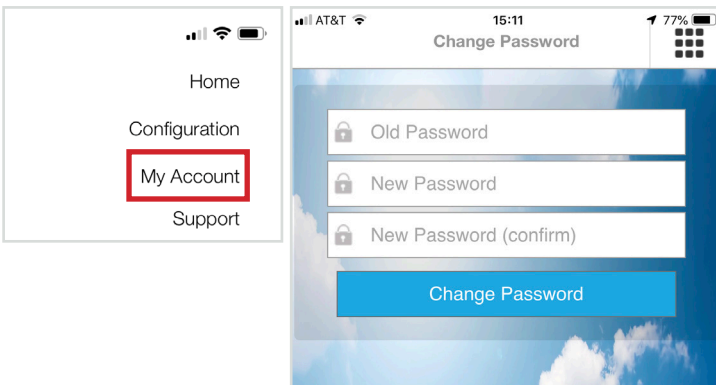

My new Password is: _____

SUPPORT AND TROUBLESHOOTING

From the main menu , choose the “Support” page. Use this page to send us questions, feedback on problems, improvement ideas and any additional comments you may have.

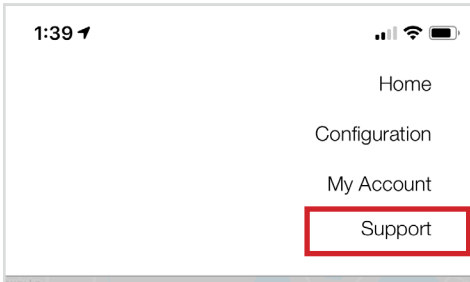

For troubleshooting, send us an email from the **application's** support page:

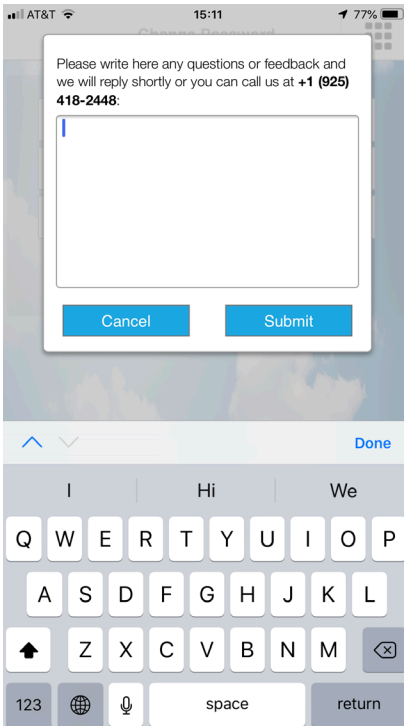

To send us an image or video showing the problem, please email us directly: support@boatinnovation.com

You can find useful troubleshooting tips on our website:

automaticfender.com/support

You are welcome to call us at: 925-418-2448 [California, USA].

SUSPENDING FENDER MOVEMENT

To disable movement on any given fender, press the fender icon .

A suspended fender will show as gray  and will not react to commands. To activate a suspended fender, press on the fender icon again.

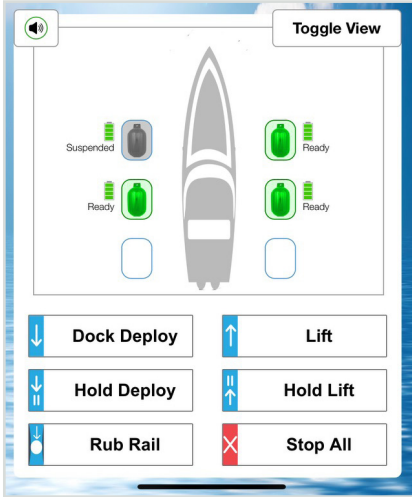

CARE AND MAINTENANCE

To keep the AF white and shiny for years to come, polish and wax all white AF surfaces. Use marine boating approved polishing and waxing products. If the boat is normally docked in a covered area, waxing and polishing every other year is sufficient. If the boat is not normally docked in a covered area, waxing and polishing should be done twice a year.

The solar cells should not be polished or waxed, please keep them clean using only a cloth and water.

Enjoy the AFs for a few cruises, afterwards cut off the extra line wrapped on the Stanchion :



It is best to have a knot with the extra line pointing towards the boat:

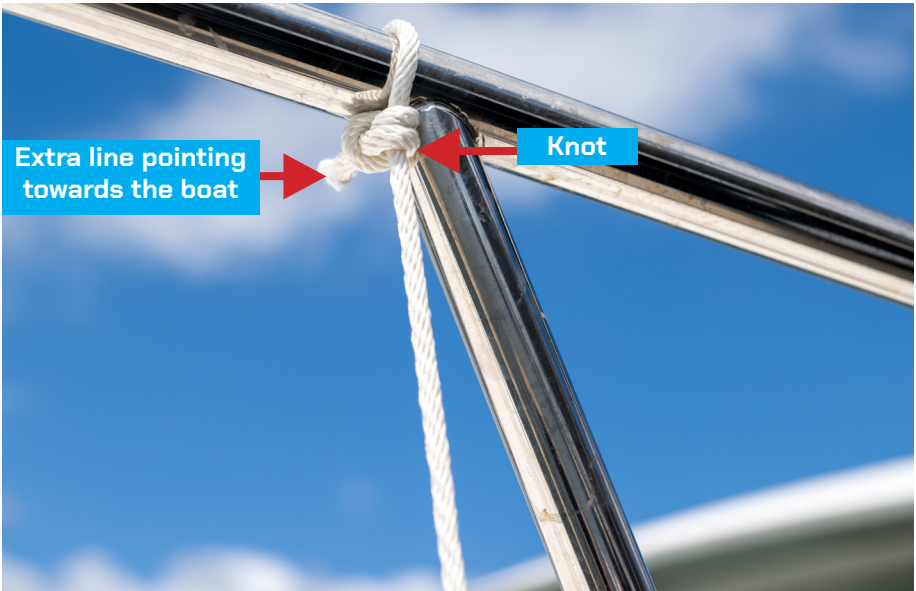

If a front clamp was used in a unique installation, you can add the provided stickers to the front clamp.

UNIQUE INSTALLATIONS

Needed only if the standard installation didn't work:

If the AF is sticking beyond the rub-rail, or if you are worried about hitting anything while docking, then the AF can be installed inside the railing. Remove the 6" bolt, **only on one side:**

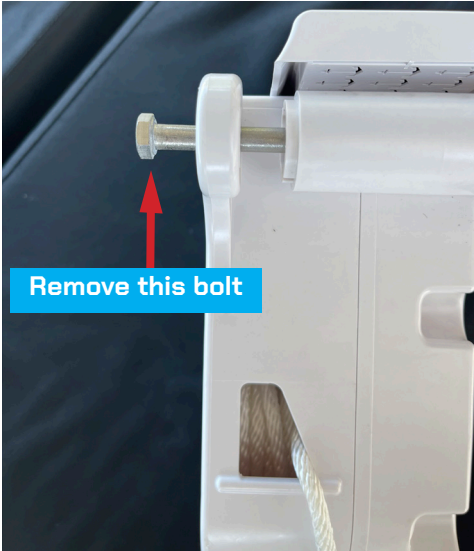

Removing both 6" bolts at the same time may cause confusion, as the clamps are not identical. Remove the spacer:



Connect the clamps to the AF using the provided 5/16" x 2-1/4" bolt.

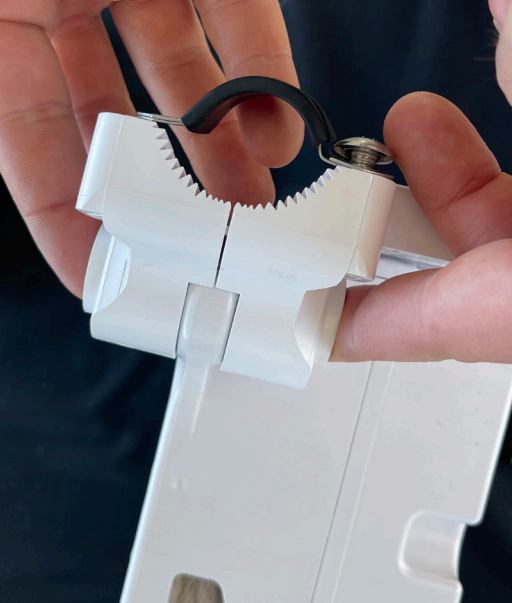

Repeat on the other side of the AF.

Install the AF inside the railing (without the spacer):



Continue the installation from page 9 onwards.

ADDING A FRONT CLAMP (IF NEEDED):

If the line can not be tied to the railing the provided front clamp can be added:



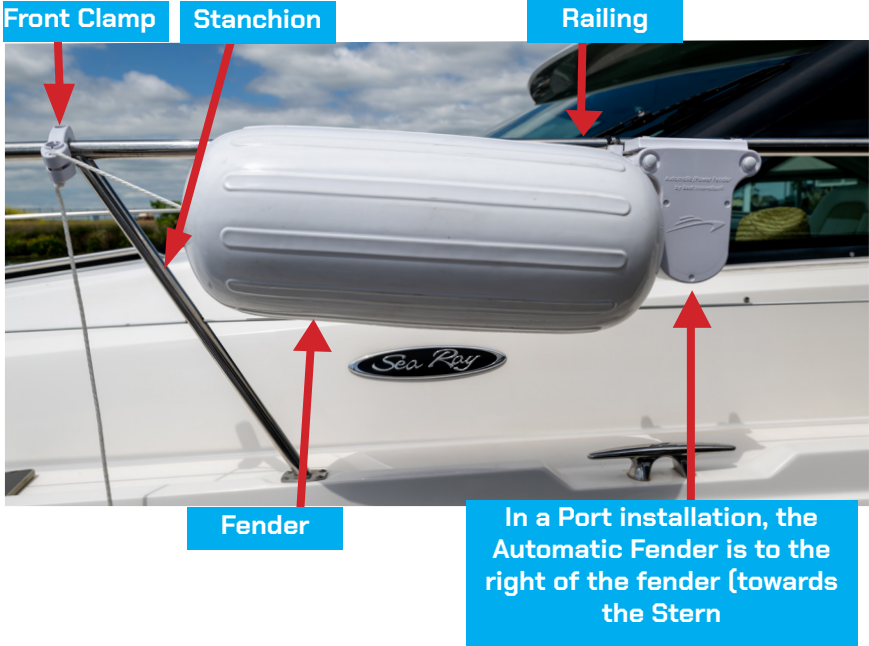

Install the front clamp on the railing in front of the stanchion, Do not skip a stanchion :



If the clamps are too wide, add the provided bushings.
Trim the bushings as needed (often only half is needed).



Insert the line from the outside in, towards the Boat, through the front clamp's small hole. Tie a knot.



Continue the installation from page 9 onwards.

For additional unique installations
and Q&A please check our website:
automaticfender.com/support

SCAN THIS:



Replaceable Solar Cell:

The Solar cell on the Automatic Fenders is a Serviceable part. Depending on the weather conditions and location, the Solar Cell may need to be replaced after a few years. We are monitoring each AF's performance and will contact you if your solar needs service.



We highly appreciate reviews with pictures on [Google](#). To show our appreciation, we will extend your valid warranty by one additional year for FREE!!!

Scan me to review:



Thank You!

Thank you for your Automatic Fender purchase!

To help your friends and family with their safe boating adventures, we offer an exclusive \$50 discount on their Automatic Fender set purchase!

They can use this promo code at checkout: ThankYou



Updated: January 7, 2025 7:37 PM